

# Yuba City Lighting and Landscape Maintenance Districts Nos. 1-6

August 21, 2018

Benjamin Moody, Deputy Public Works Director – Engineering





# Yuba City Lighting & Landscape Maintenance Districts

<u>District</u>	<u>Revenue</u>	<u>Expenditures</u>	<u>Projected Reserve Fund Balance as of 7/1/19*</u>
<b>1</b>	\$87,841	\$127,700	\$46,403
<b>2</b>	\$76,699	\$72,616	\$33,739
<b>3</b>	\$7,088	\$8,447	\$24,884
<b>4</b>	\$120,283	\$131,984	\$126,918
<b>5</b>	\$385,328	\$452,258	\$531,224
<b>6</b>	\$23,508	\$17,997	\$95,082

\*The Projected Reserve Fund Balance is the total of the Capital Replacement Reserve plus Operating Reserve.



District	Zone of Benefit	FY 2018/19 Proposed Levy (\$)	Change From Previous Year (\$)	Maximum Levy Allowed (\$)
1	A	\$56.72	\$0.00	\$56.72
	B	\$29.50	\$0.00	\$29.50
	B_1	\$30.53	\$0.00	\$30.53
2	A	\$570.89	\$11.58	\$570.89
3	A	\$80.54	\$3.84	\$162.34
4	A	\$209.19	\$9.96	\$425.05
	B	\$209.19	\$9.96	\$575.64
	C	\$209.19	\$9.96	\$349.28
	D	\$209.19	\$9.96	\$312.94

District	Zone of Benefit	FY 2018/19 Proposed Levy (\$)	Change From Previous Year (\$)	Maximum Levy Allowed (\$)
5	A	\$146.25	\$6.96	\$207.12
	B	\$60.57	\$2.88	\$69.53
	C	\$118.29	\$5.63	\$150.11
	D	\$88.48	\$4.21	\$206.13
	E	\$45.20	\$2.15	\$85.13
	F	\$88.24	\$2.00	\$167.49
	G	\$49.42	\$2.35	\$52.37
	H	\$33.65	\$1.17	\$33.65
	I	\$64.33	\$3.06	\$70.56
	J	\$56.33	\$2.68	\$189.05
	K 1-17	\$177.73	\$3.27	\$267.47
	K 18	\$173.47	N/A	\$352.90
L	\$101.11	\$4.82	\$124.67	

District	Zone of Benefit	FY 2018/19 Proposed Levy	Change From Previous Year (\$)	Maximum Levy Allowed (\$)
6	A_1	\$288.31	\$5.85	\$288.31
	A_2	\$288.31	\$5.85	\$288.31
	A_3	\$288.31	\$5.85	\$288.31
	B_1	\$463.58	\$9.40	\$463.58
6	B_2	\$425.95	\$8.64	\$425.95
	B_3	\$293.02	\$5.94	\$293.02
	B_4	\$1,546.48	\$31.37	\$1,546.48
	B_5	\$0.00	\$0.00	\$441.86
	B_6	\$85.21	\$1.73	\$85.21
	B_7	\$85.21	\$1.73	\$85.21
	B_8	\$194.81	\$3.95	\$194.81
	B_9	\$385.67	\$7.83	\$385.67



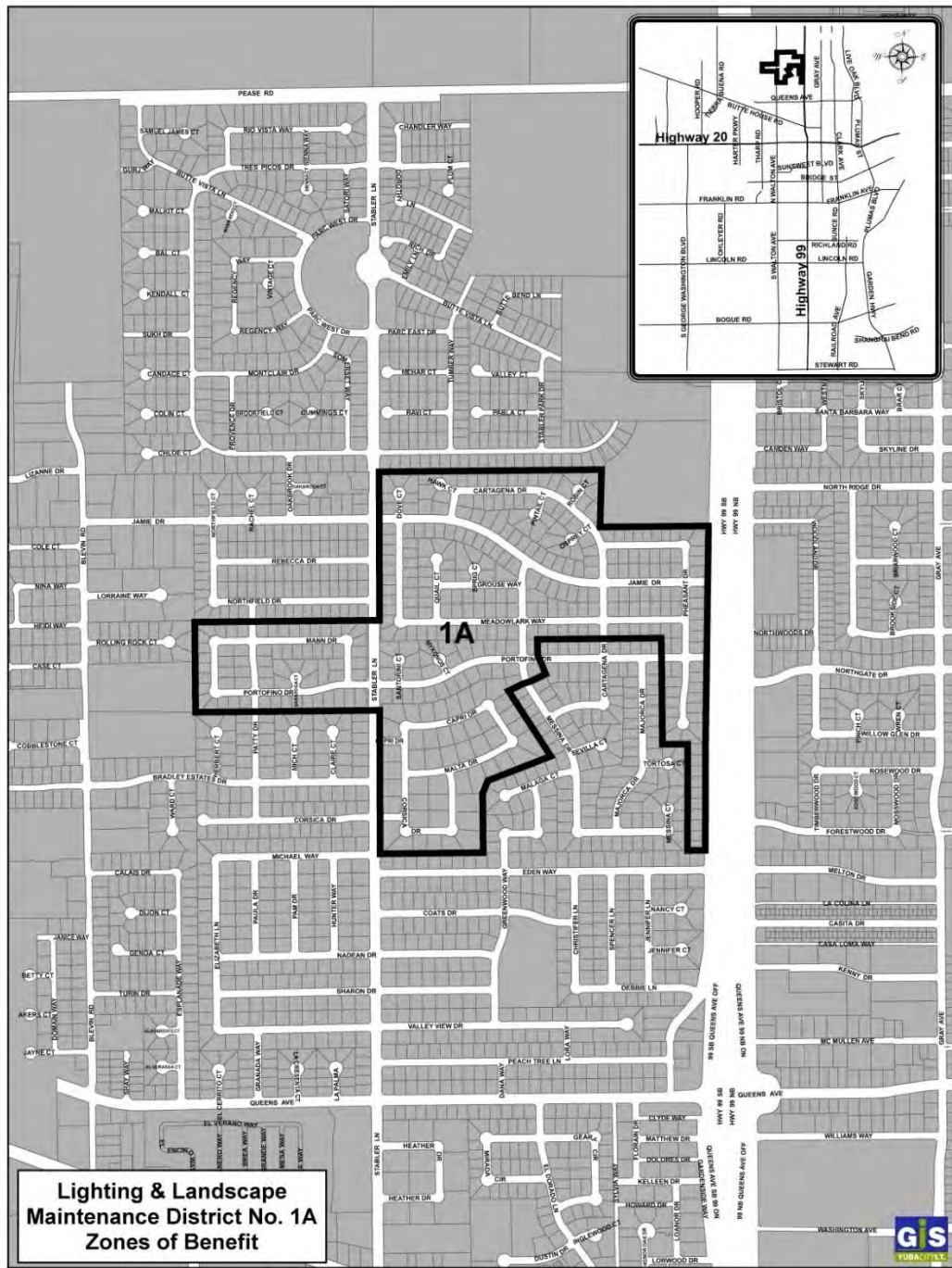

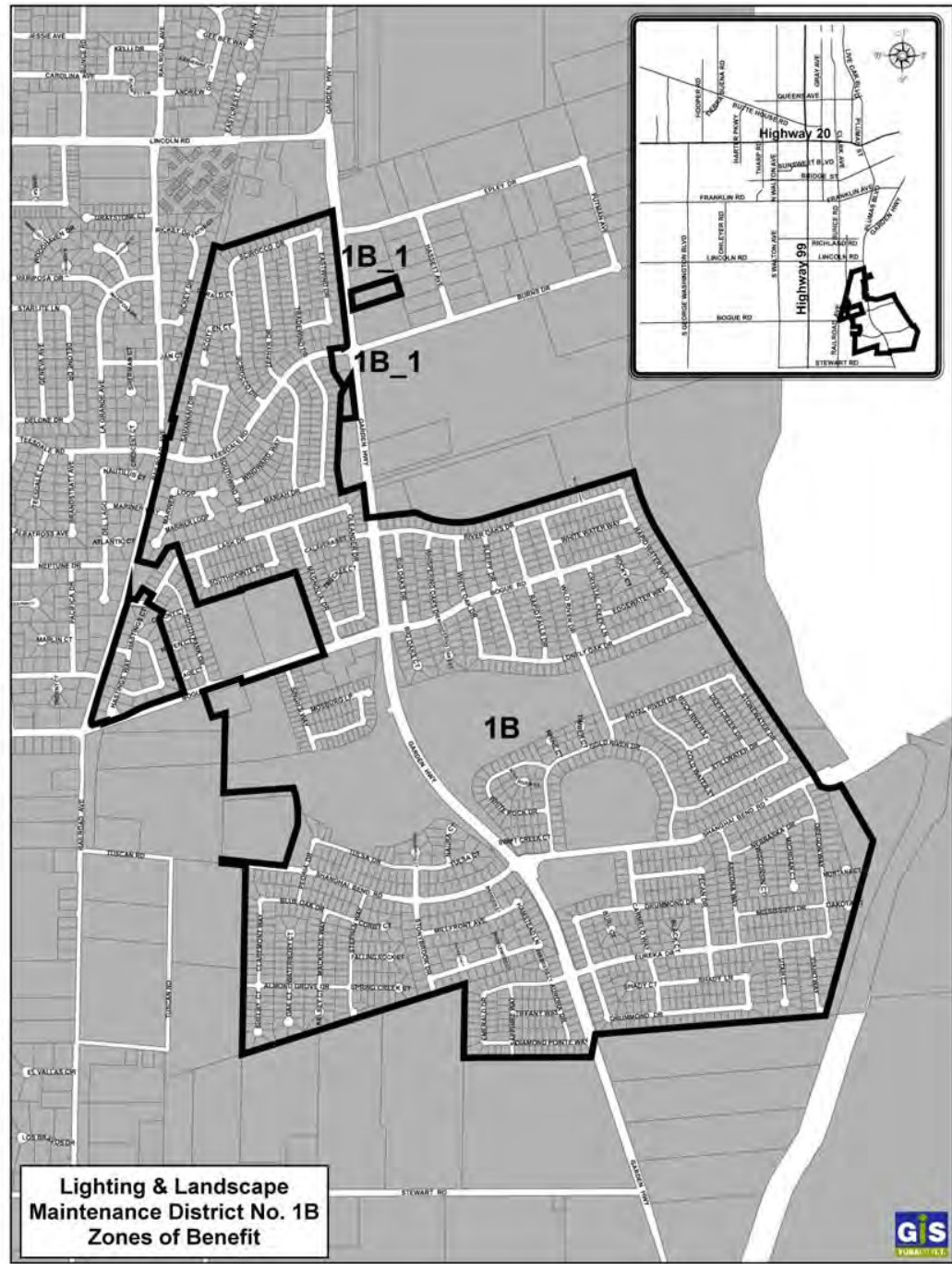

**Lighting & Landscape  
Maintenance District No. 1B  
Zones of Benefit**



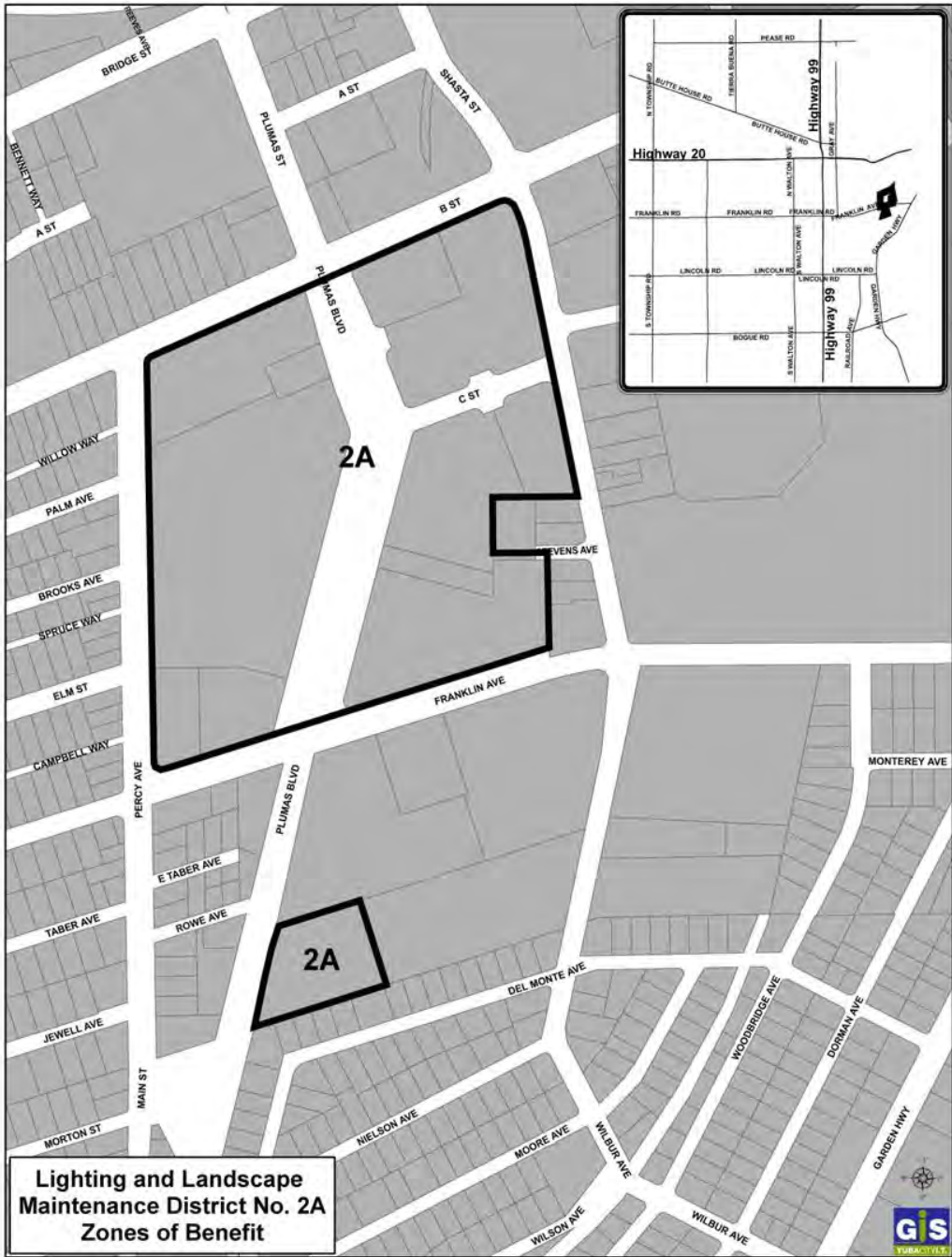





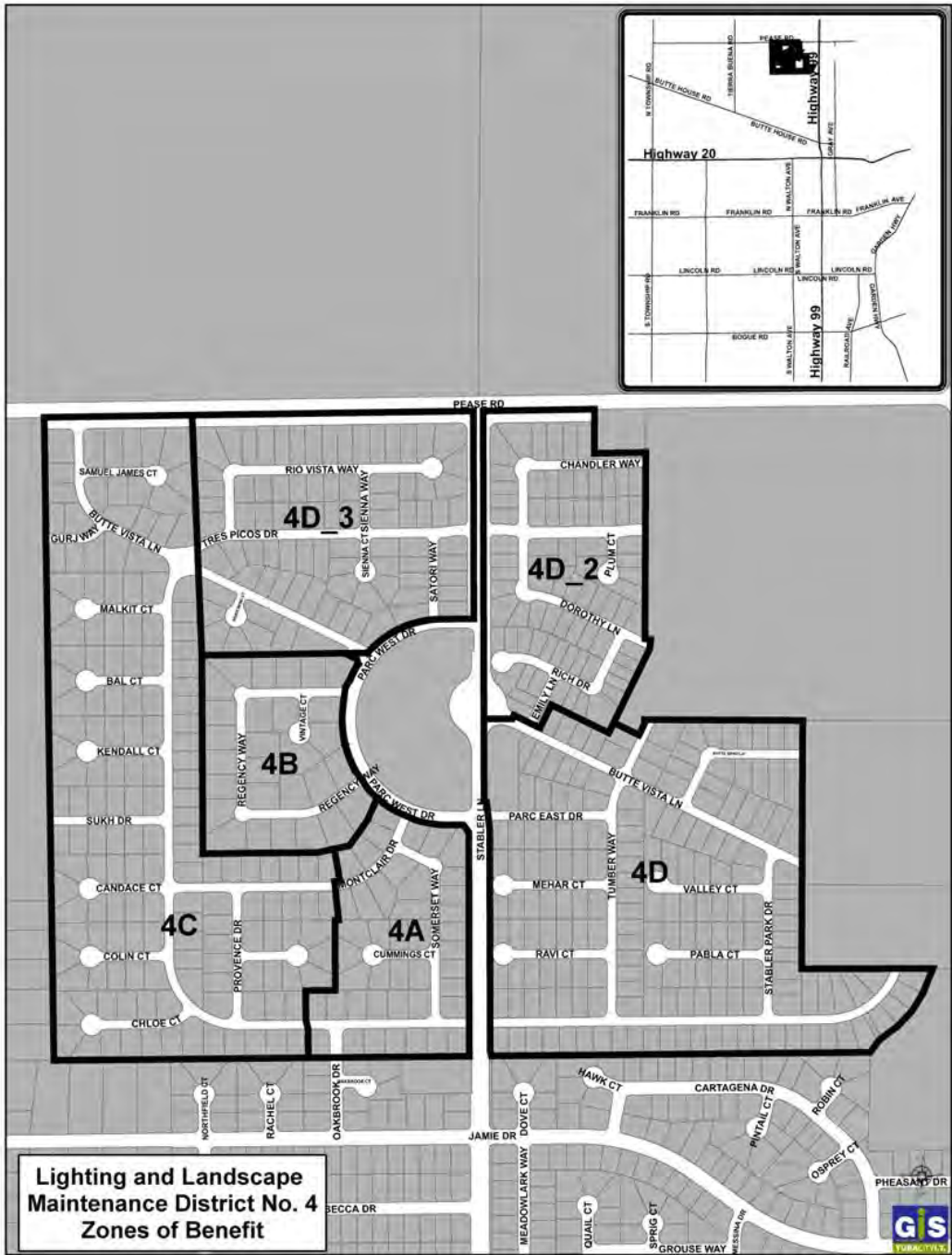

**Lighting and Landscape  
Maintenance District No. 4  
Zones of Benefit**



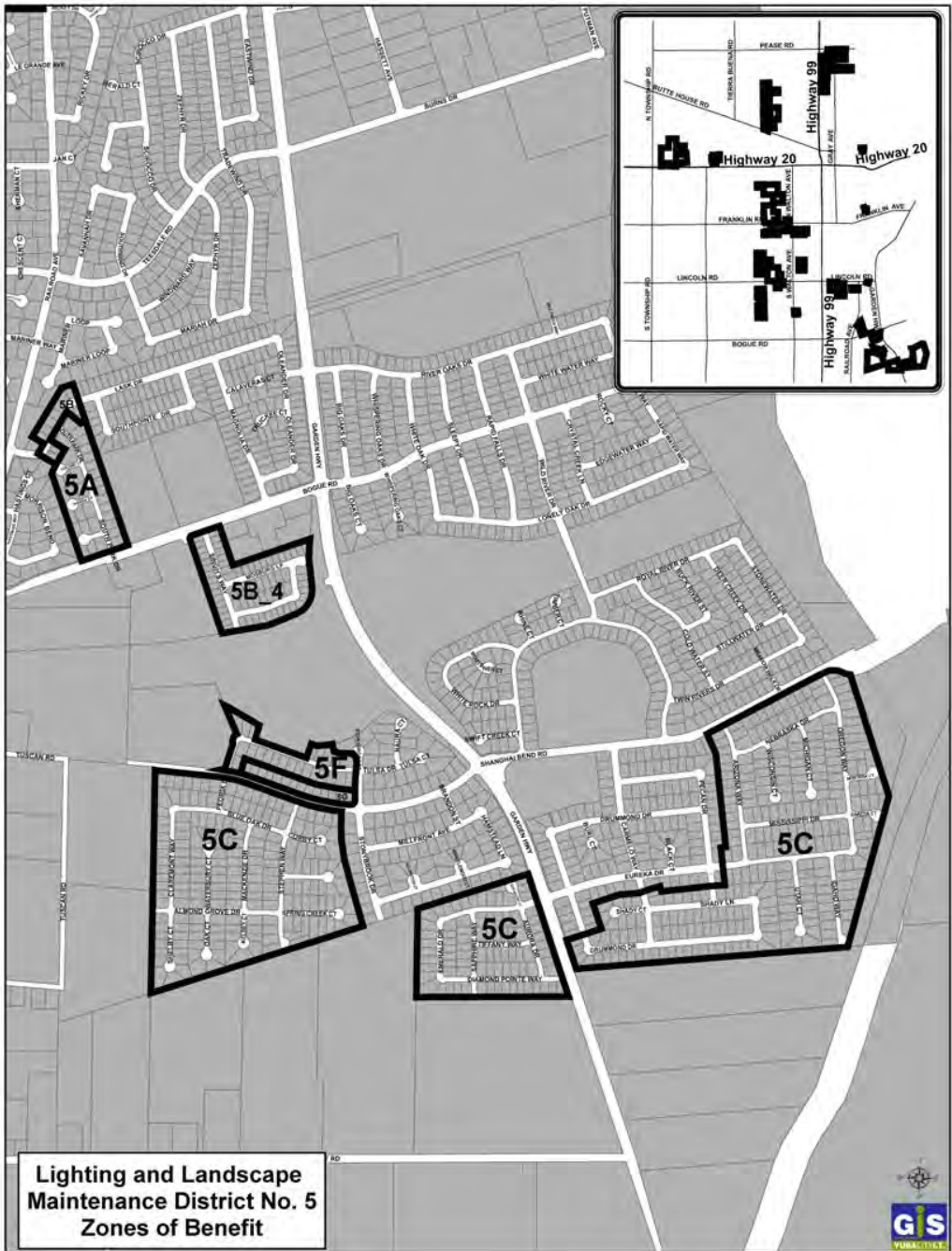

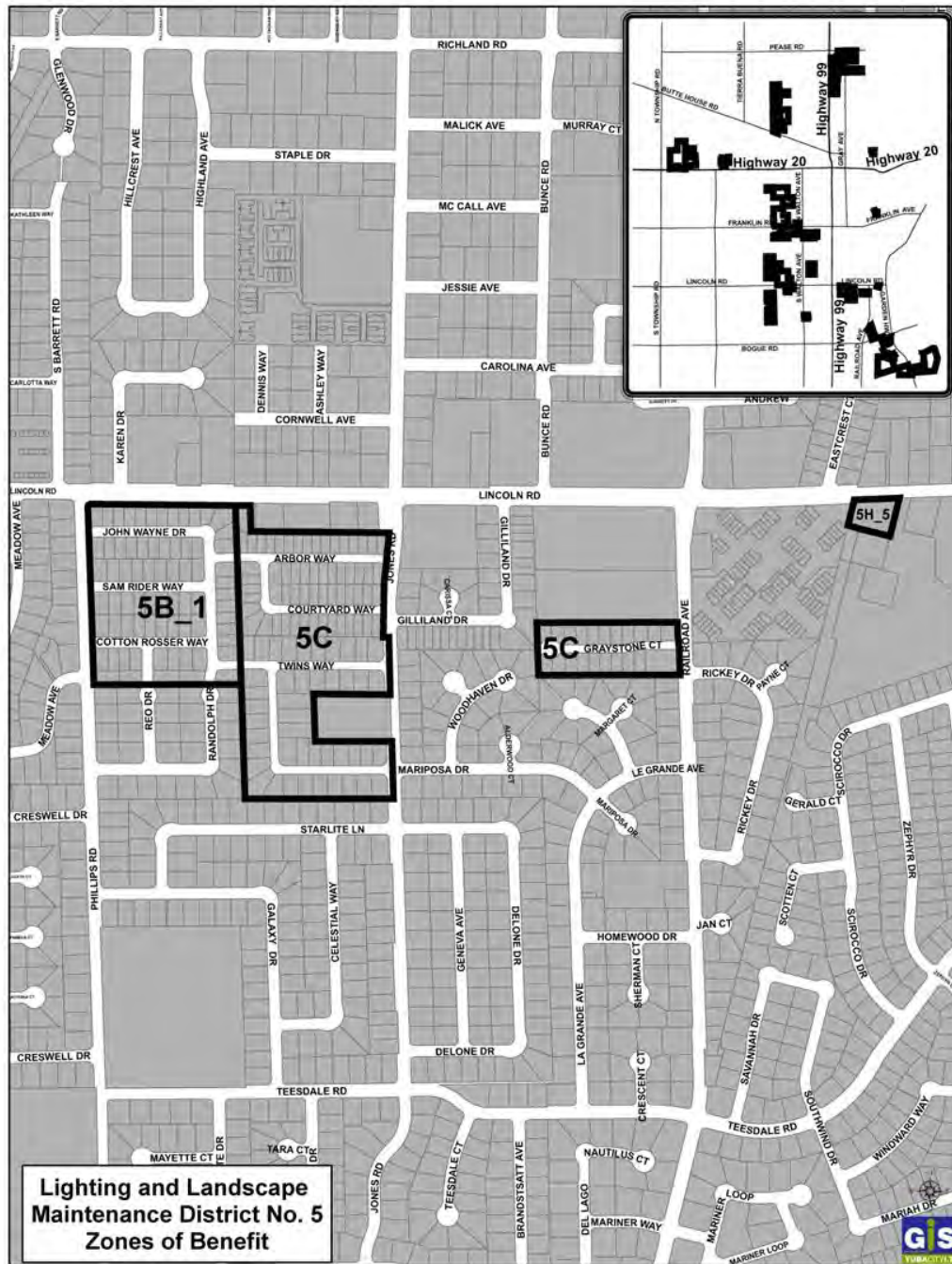

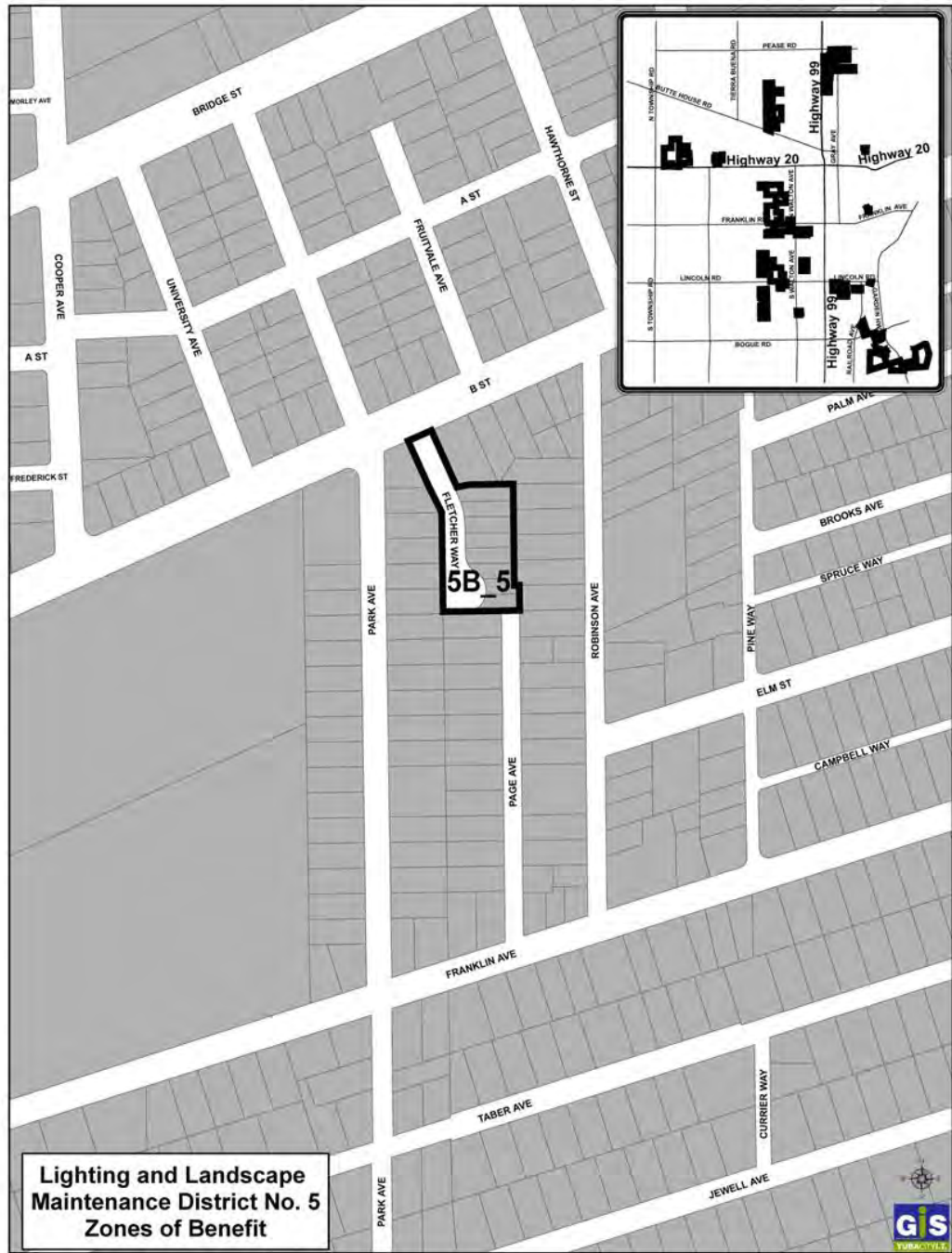

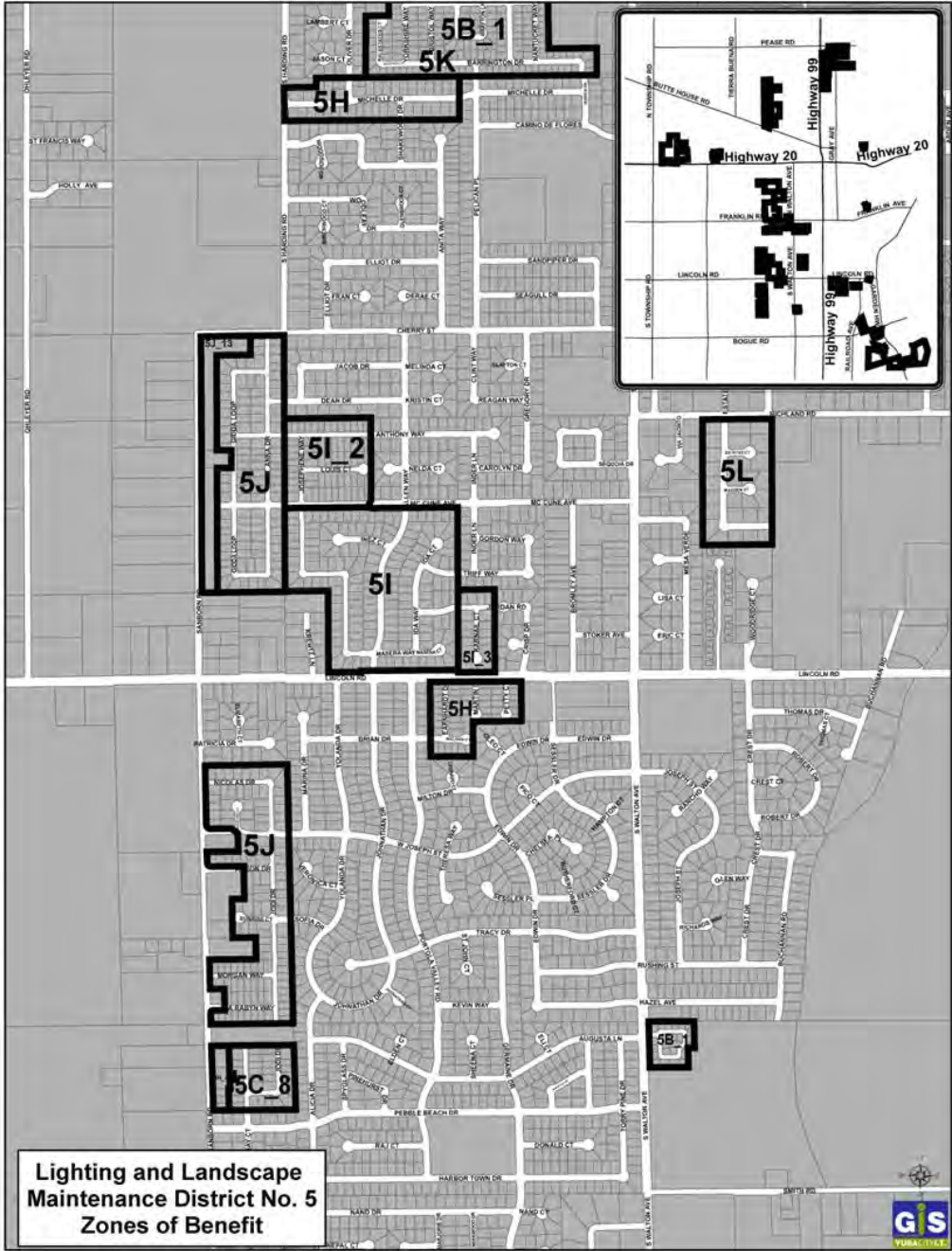

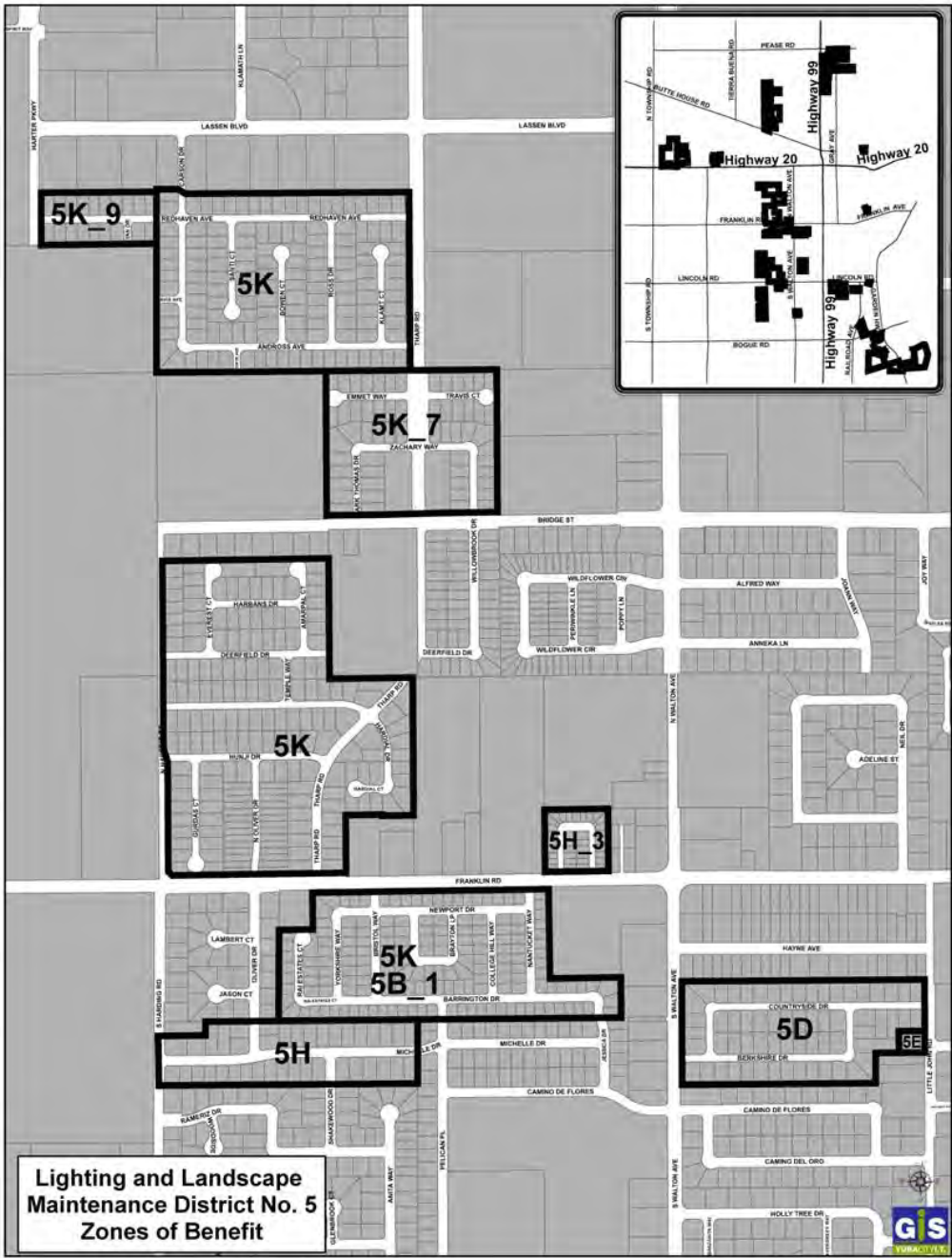

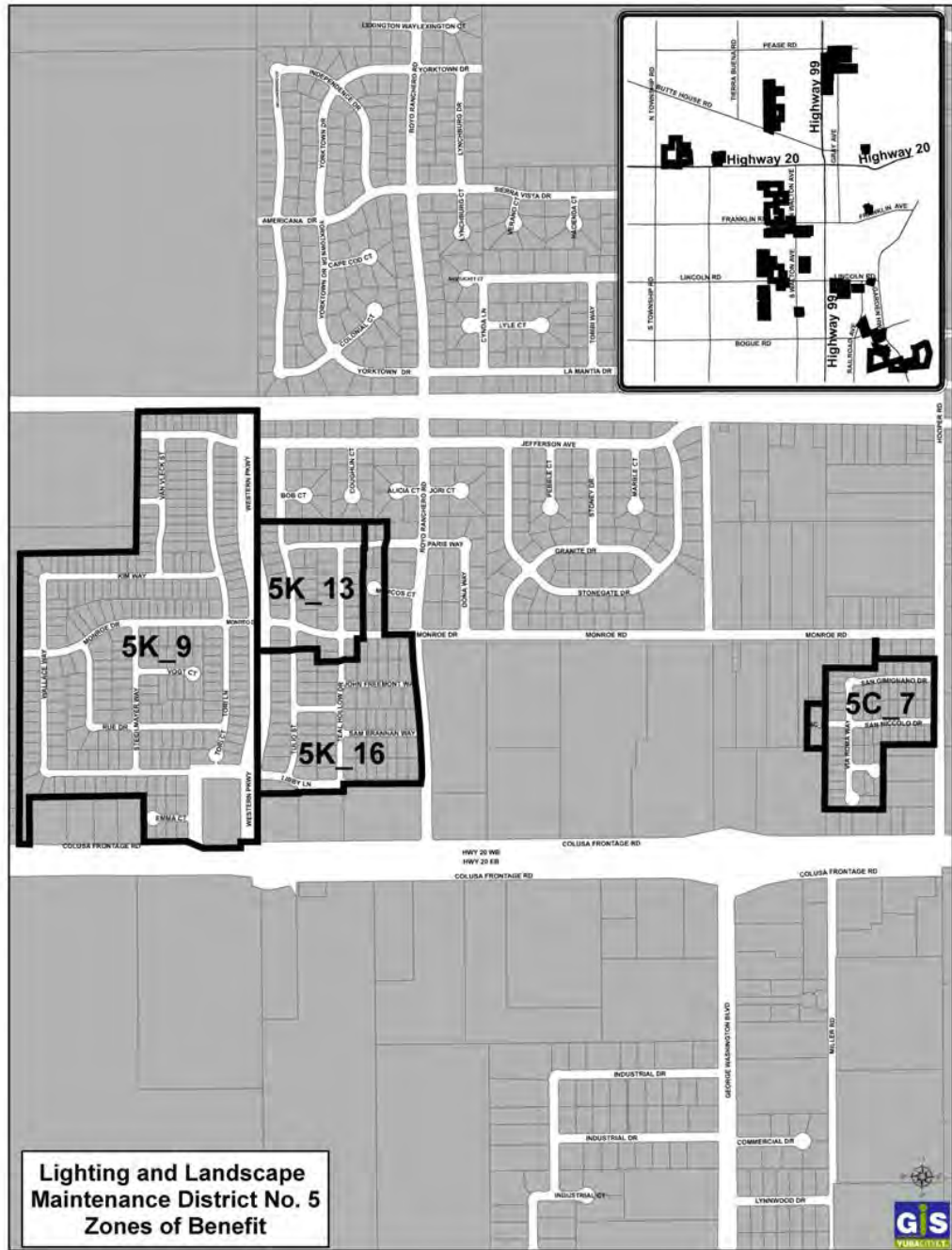

**Lighting and Landscape  
Maintenance District No. 5  
Zones of Benefit**





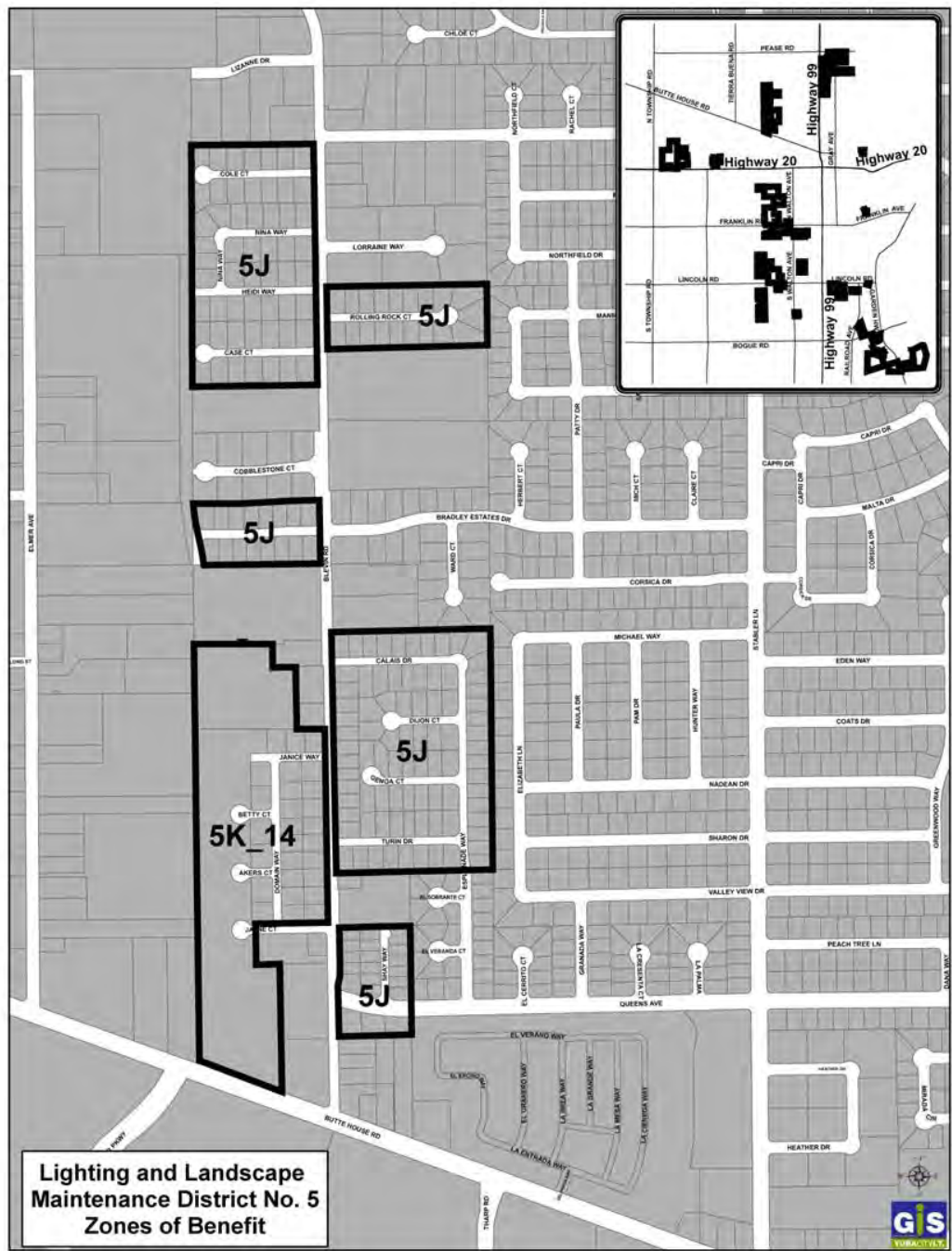

**Lighting and Landscape  
Maintenance District No. 5  
Zones of Benefit**



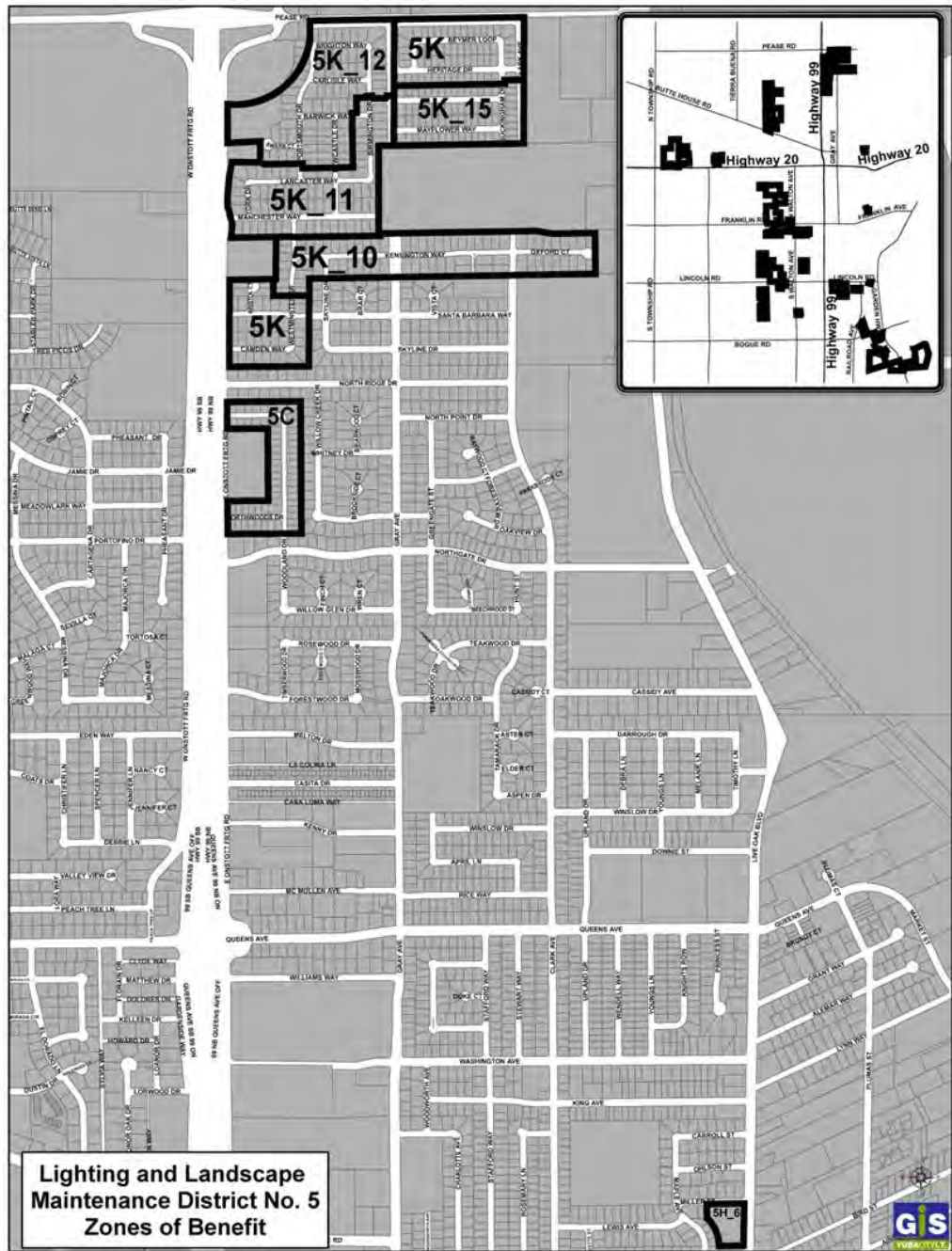

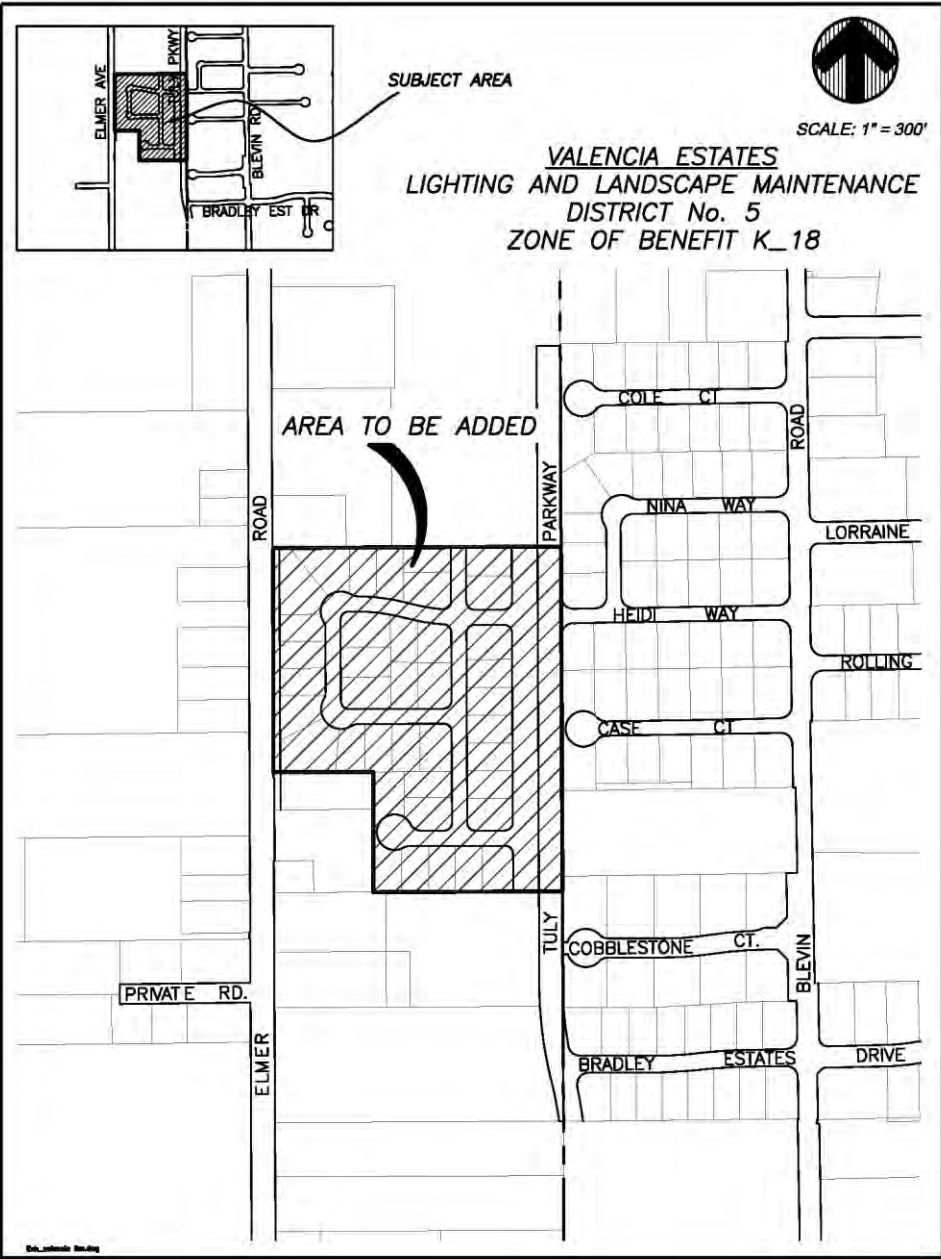

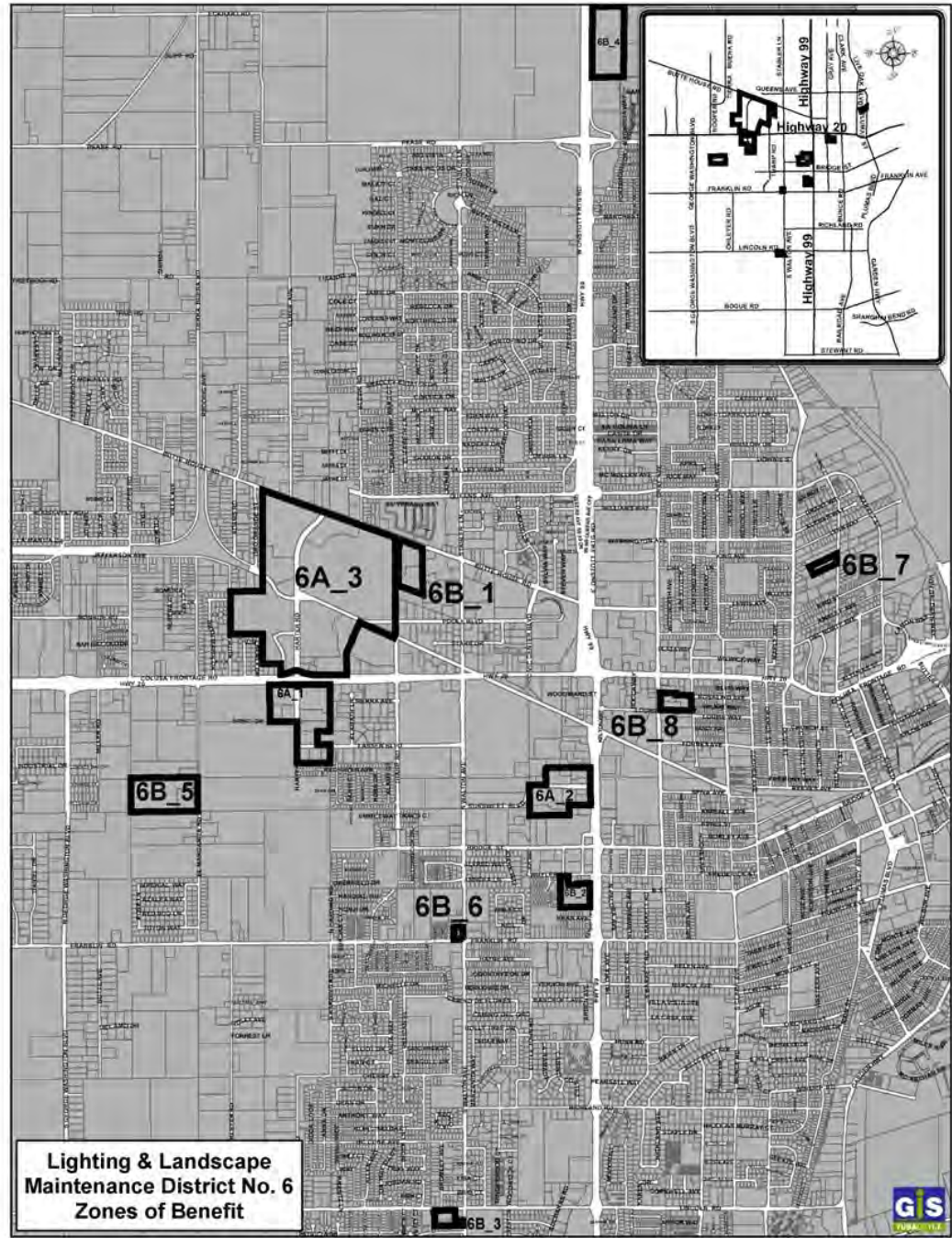

**Lighting & Landscape  
Maintenance District No. 6  
Zones of Benefit**

