



Yuba City Lighting and Landscape Maintenance District Nos. 2-6 August 16, 2022



**Presentation By:
Josh Wolffe, Associate Civil Engineer**

Yuba City Lighting and Landscape District Nos. 2-6 Background



- City annually levies and collects special assessments to maintain and service landscaping and lighting improvements
- Assessments approved by property owners
- District Nos. 2-6 have provisions for a Cost of Living Adjustment (COLA)
- COLA is based on Consumer Price Index (CPI) from January to January
 - COLA increased 7.48% from last year

Yuba City Lighting and Landscape District Nos. 2-6 Background (cont.)



- July 5, 2022: Council ordered Engineer to file reports for Districts
- July 19, 2022: Council adopted Resolutions approving reports, and Resolutions setting a Public Hearing for August 16, 2022

Yuba City Lighting and Landscape District Nos. 2-6 Analysis



- Engineer's Reports are on file in City Clerk's Office
- Reports describe each District, improvements, methods of assessment, and proposed assessment for each parcel
- Districts 3, 4, 6 District 5 Zones of Benefit B-L will see increases in annual levies
- District 2 (Zone of Benefit A) and District 5 (Zone of Benefit A) will see decreases in levies

Yuba City Lighting and Landscape District Nos. 2-6 Fiscal Impact

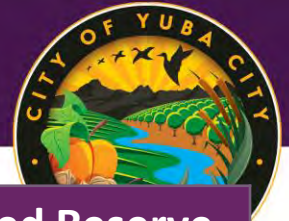

<u>District – Zone of Benefit</u>	<u>Revenue</u>	<u>Expenditures</u>	<u>Projected Reserve Fund Balance as of 7/1/22*</u>
2	\$83,732	\$41,035	\$111,665
3	\$10,662	\$8,676	\$27,566
4	\$153,205	\$135,737	\$144,411
5	\$576,028	\$577,970	\$221,880
6	\$29,125	\$14,792	\$141,897

*The Projected Reserve Fund Balance is the total of the Capital Replacement Reserve plus the Operating Reserve.

Yuba City Lighting and Landscape District Nos. 2-6 Alternatives



- Modify assessment amounts or cancel Districts and fund lighting, landscaping and various other items with alternative sources

Yuba City Lighting and Landscape District Nos. 2-6 Recommendation



- Conduct a Public Hearing
- Adopt a Resolution confirming and ordering the annual levy of assessments for Fiscal Year 2022-23 for the Yuba City Lighting and Landscape Maintenance District Nos. 2, 3, 4, 5, & 6 (Town Center, 69 subdivisions throughout Yuba City including the Palisades Subdivisions and Butte Vista neighborhood, and commercial district)

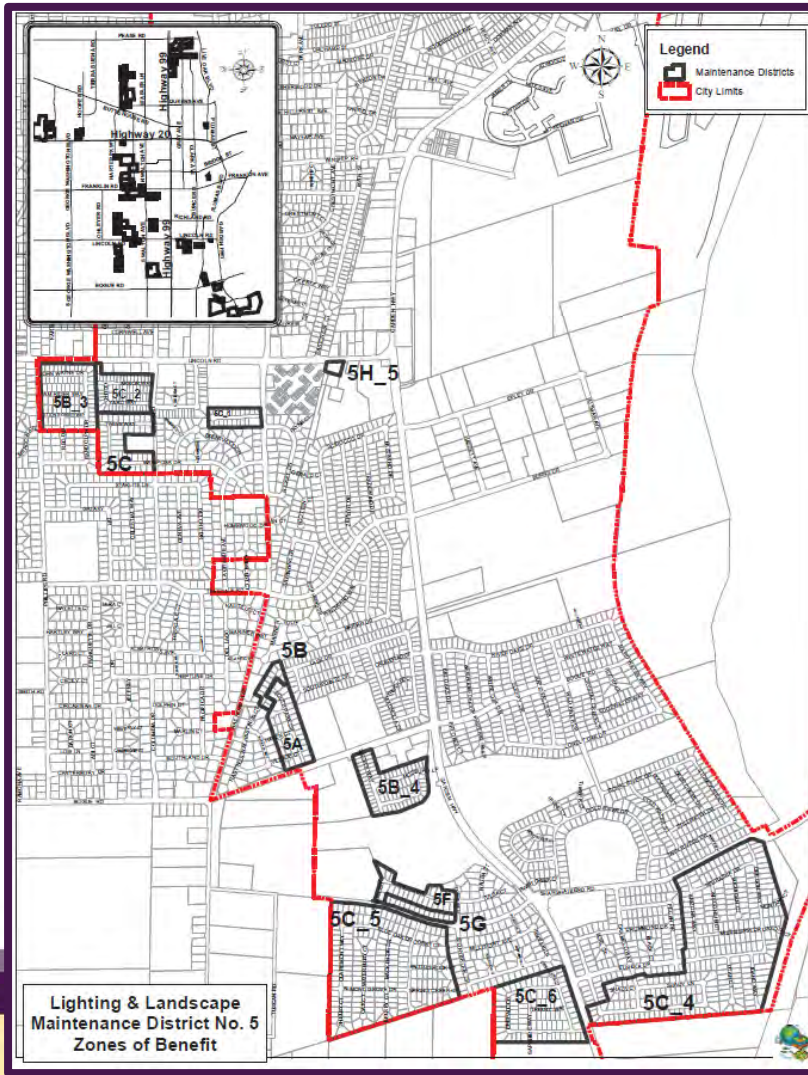



Legend

-  Maintenance Districts
-  City Limits

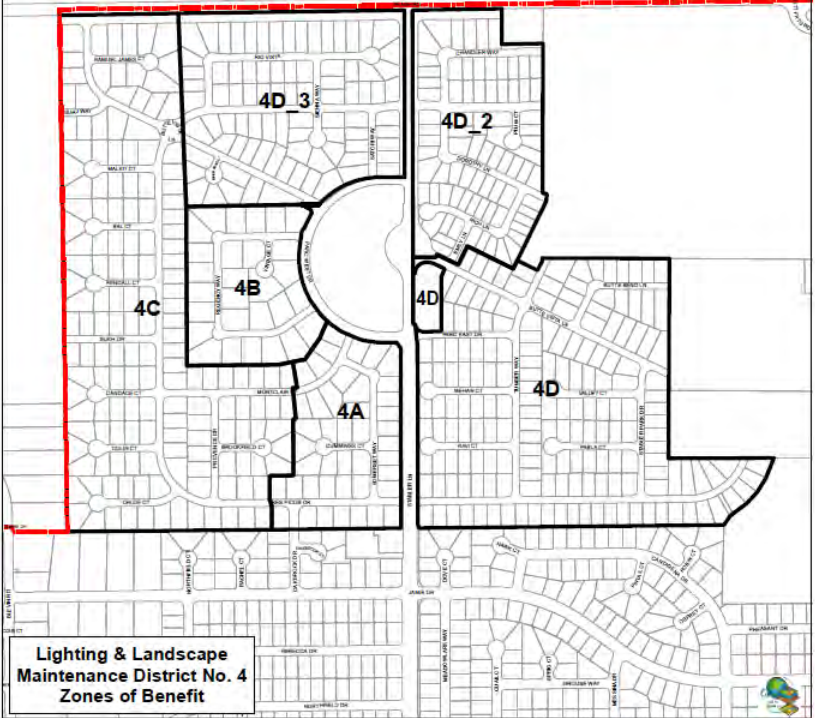

**Lighting & Landscape
Maintenance District No. 4
Zones of Benefit**



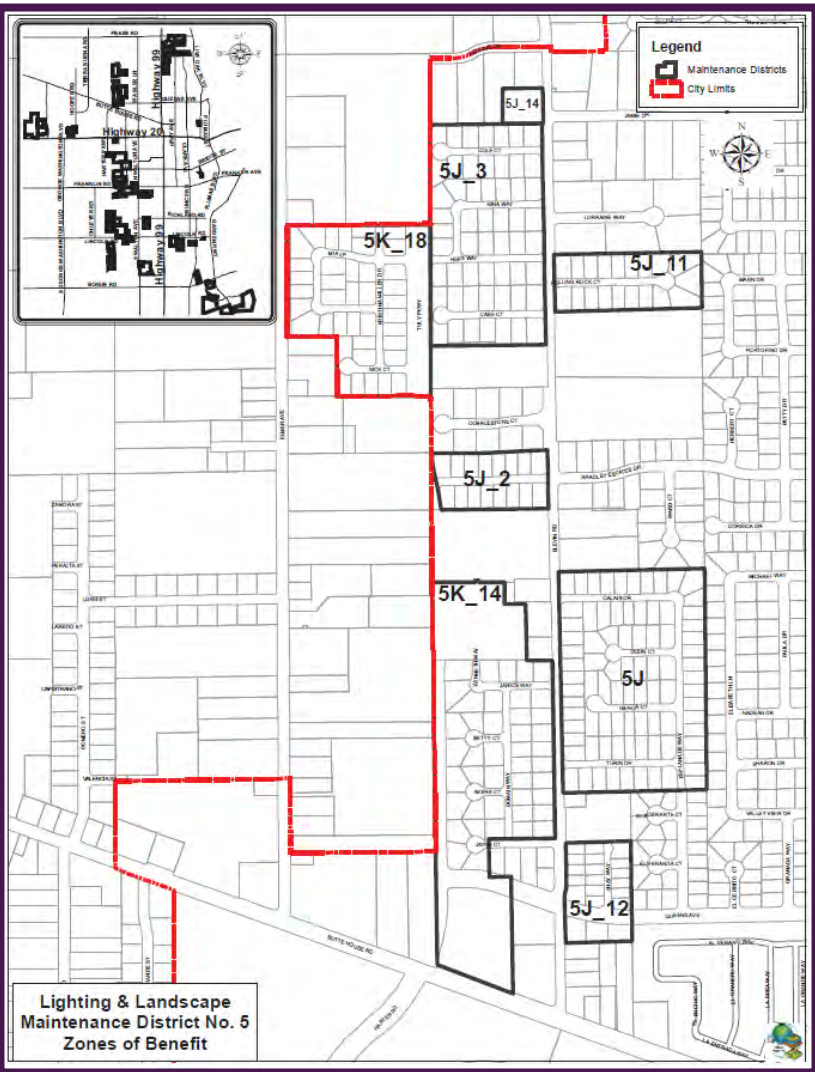

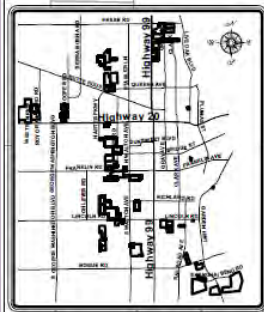

Legend
Maintenance Districts
City Limits

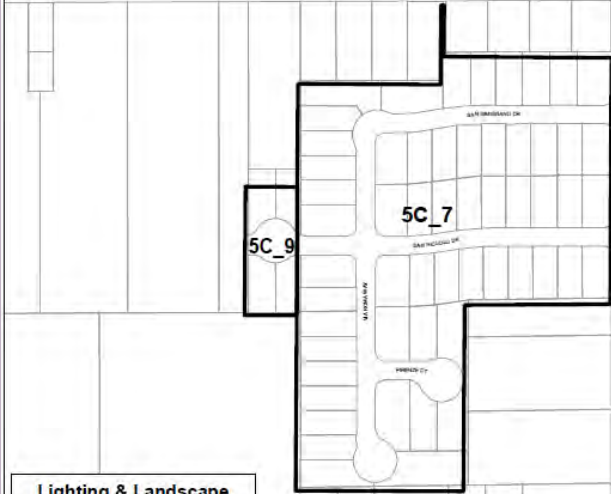
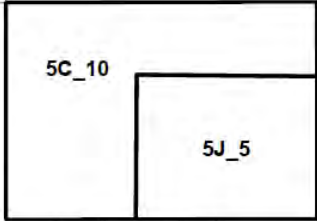

Lighting & Landscape
Maintenance District No. 4
Zones of Benefit



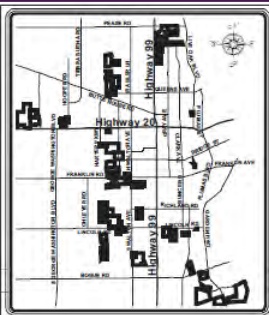

Legend

- Maintenance Districts
- City Limits

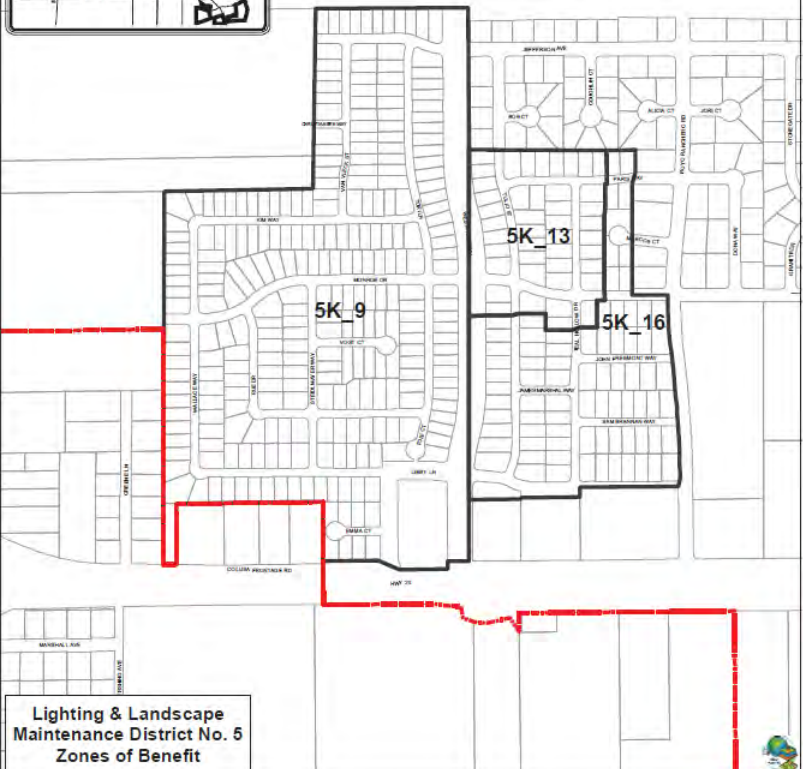

**Lighting & Landscape
Maintenance District No. 5
Zones of Benefit**



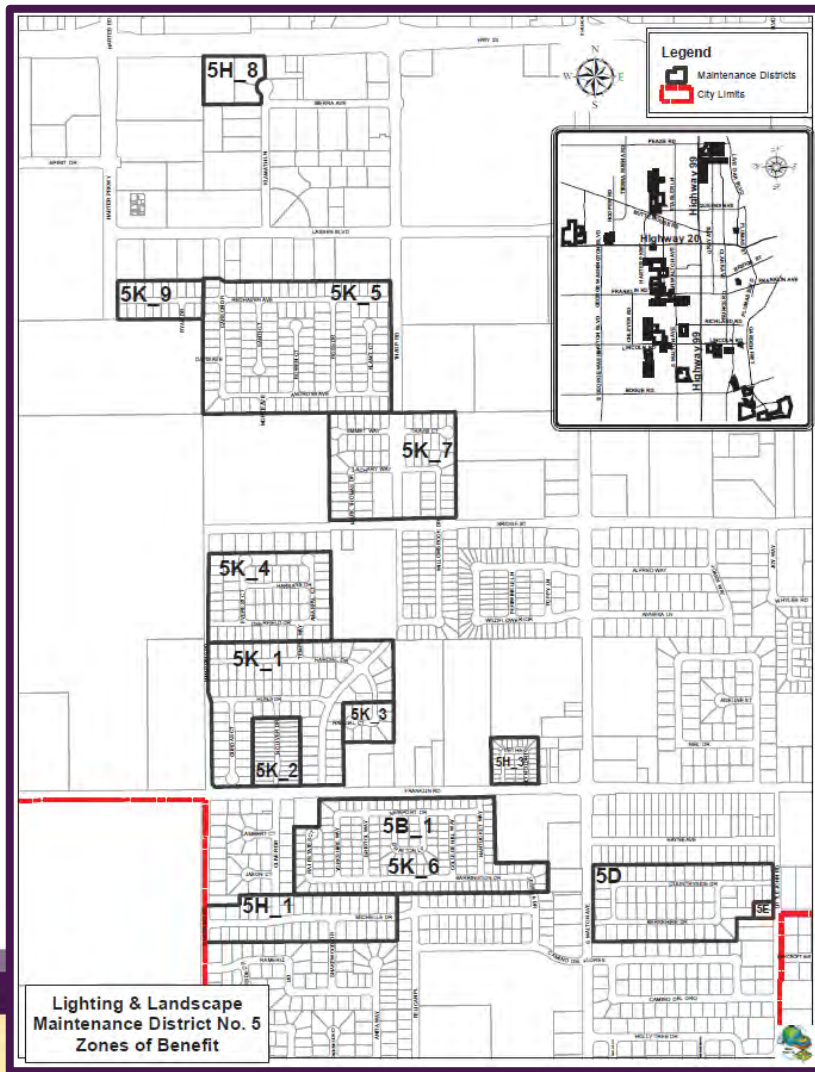

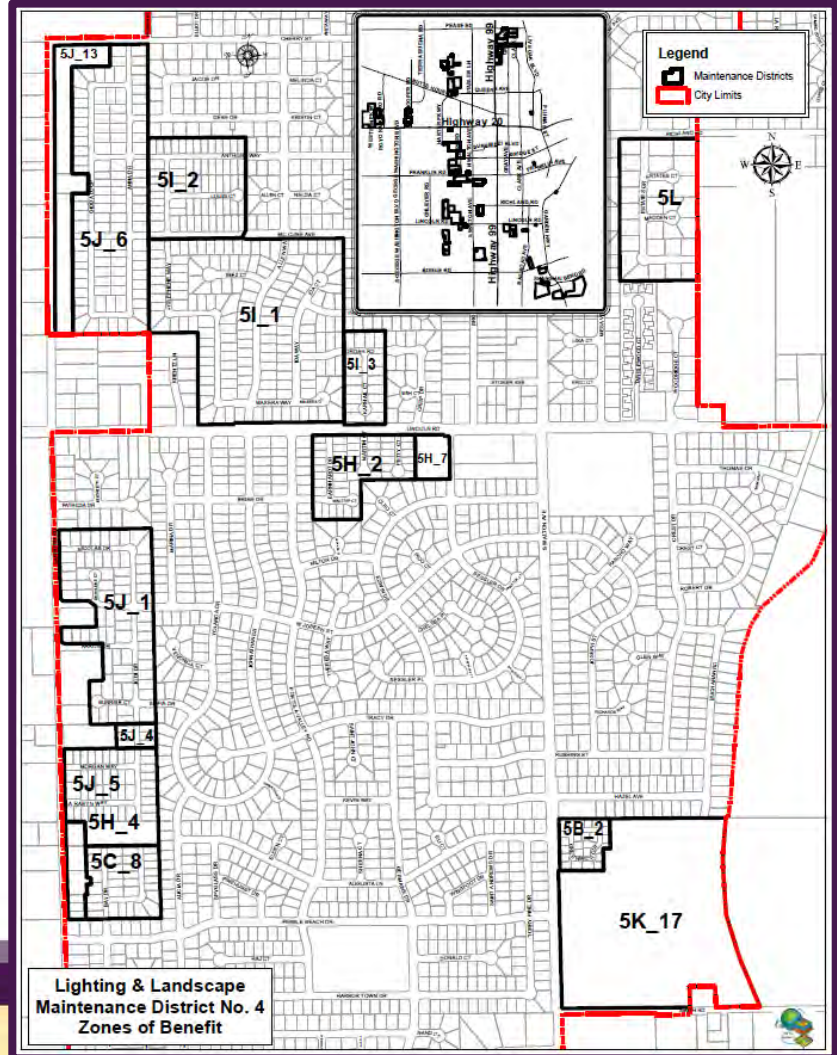

**Lighting & Landscape
Maintenance District No. 4
Zones of Benefit**





**Lighting & Landscape
Maintenance District No. 5
Zones of Benefit**



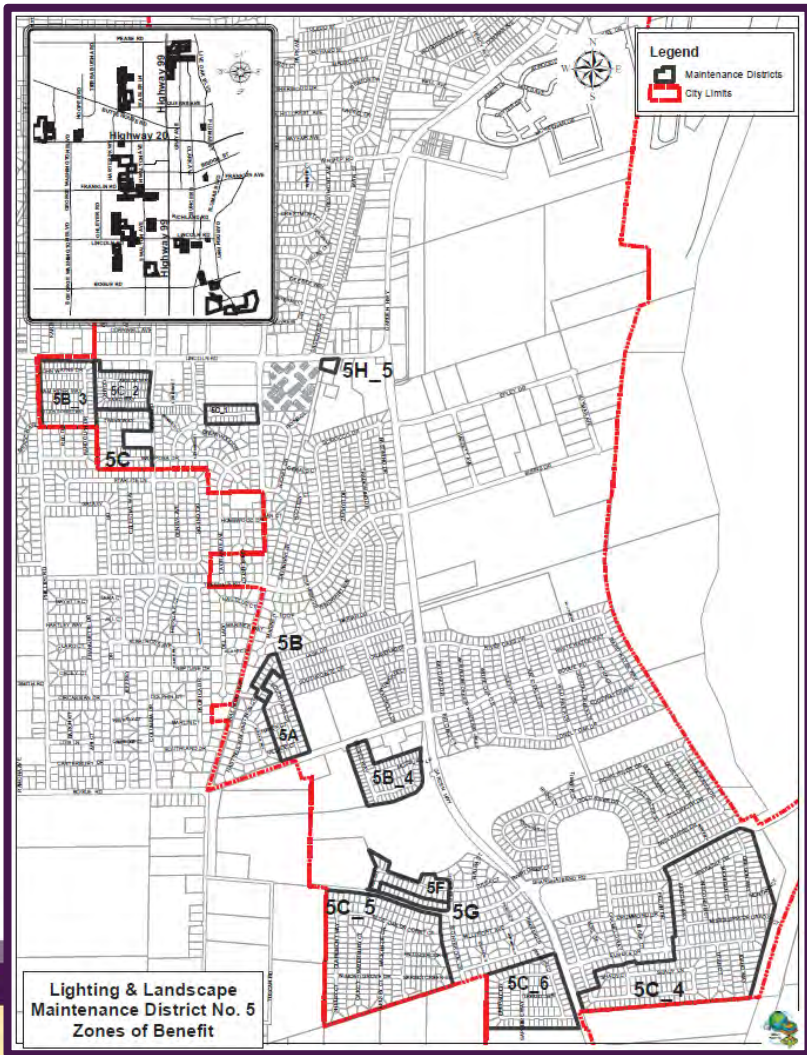

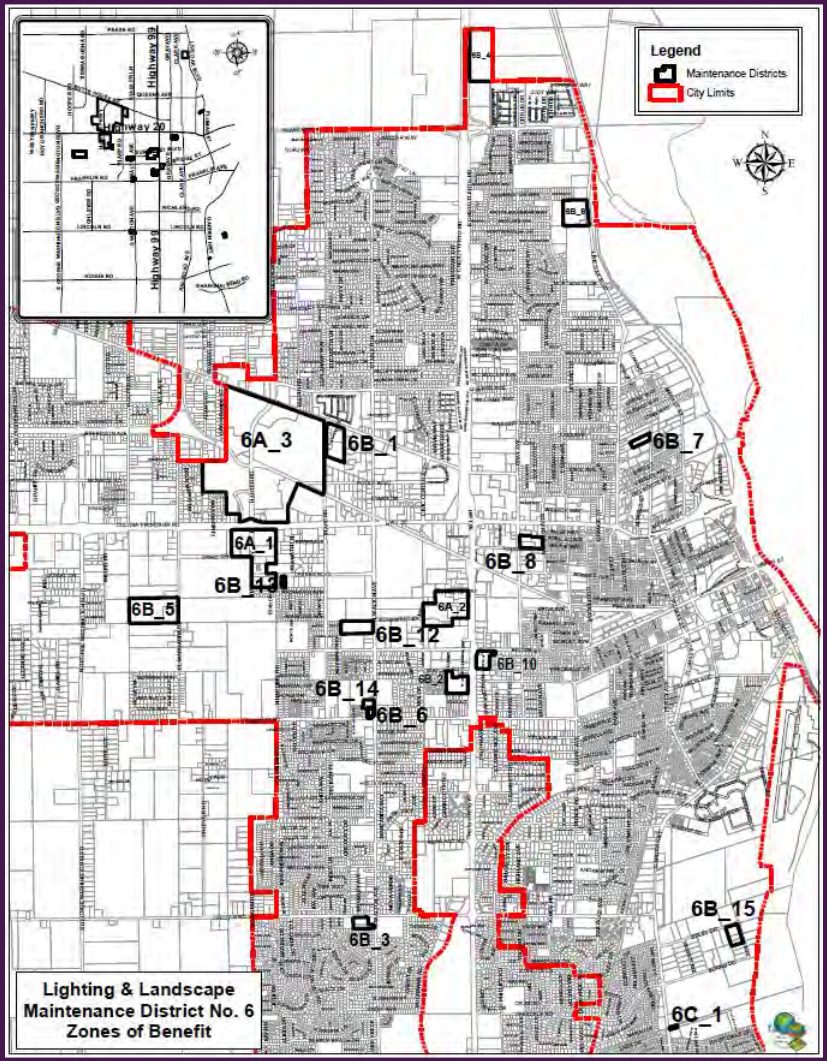

Lighting & Landscape
Maintenance District No. 6
Zones of Benefit



Yuba City Lighting and Landscape District Nos. 2-6



Questions?